

**Nohona Primary School. S.E Madagascar  
Project of TASC ADSUM Tanjomoha . Year 2019.**

**Completion Report and Pictures. Completed Nov 2020.**

Over the past 2 years and despite numerous logistical problems TASC and ADSUM have in co-operation with Foyer Tanjomoha and Pere Emeric managed to complete a new primary school at Nohona in SE Madagascar.

The old school was totally dilapidated and with no transport to and from the village building a school was a daunting prospect.

Nohona is in a very isolated region and the village has been Outcast by other parts of society for centuries.

TASC have been supporting the village for 20 years and the last major great need was a new school.

The works were impossible without first repairing the existing road and building 3 new bridges for access which were completed in 2019.

Getting materials to and from Nohona even with the new bridges has been a very slow and expensive ordeal but with the guidance from Pere Emeric and the amazing work of his volunteer engineer Gwen they have managed over a year and a half to complete the school to a high standard as can be seen from below.

This school would never have happened without the support and funding from ADSUM though the executive Gavan Lonergan and his trust and support of TASC.

It has been funded by donations from family and friends and a major donation for the bridge and roadworks from C Field construction and the Crowley family.

It was a very difficult project to complete with security issues, transport issues and Covid 19 but the dedication of the workers and villagers to make this happen is an inspiration.

TASC have committed to supporting the 6 teachers salaries for the next 5 years while waiting for a stable government and proper funding for teachers and with ADSUM's support have given bicycles to all the teachers and some of the village elders.

This has been a 20 year dream for us at TASC. This village is Pere Emeric's and our spiritual home the welcome we receive from the people and children has warmed and humbled us by their generosity and kindness in the face of years of poverty and stigmatization. They are our friends a wonderful community and education will surely make life better for the future.

Thanks to everyone.



**The new School at Nohona 2020**



**New classrooms. 2020**



**Pere Emeric with the King and his son and a teacher getting ready to open the new school.**



**Children at School for the 1<sup>st</sup> time.**



**The New External area which has a water tank and washing facility and playground.**



## **The Children of Nohona**

**The program for the school completion ran over by almost a year due to the problems with transport and Covid 19 and the difficulty in finding skilled labour to do the works and the usual scarcity of timber.**

**We managed to complete the works just on budget and have found funding for the 6 teacher's salaries for the next 5 years through the generosity of family and friends.**

**Pat O'Brien  
On Behalf of TASC**

I enclose photos of the old school .

Picture of the old dilapidated school in 2019.

I.1.1. Renovation of old 3 classroom derelict school of Nohona and new latrine



Existing 2019





**I.1.2. Renovation and the addition of two new classrooms to the Primary Public school of Nohona with 3 cubicle new latrines**



**Front (South view) 2019**



**Front (North view) 2019**

**I.2. Renovation of Primary Public school**  
**Foundation**



**Old Foundations 2019**



**Rear view and front view of the school. 2019**

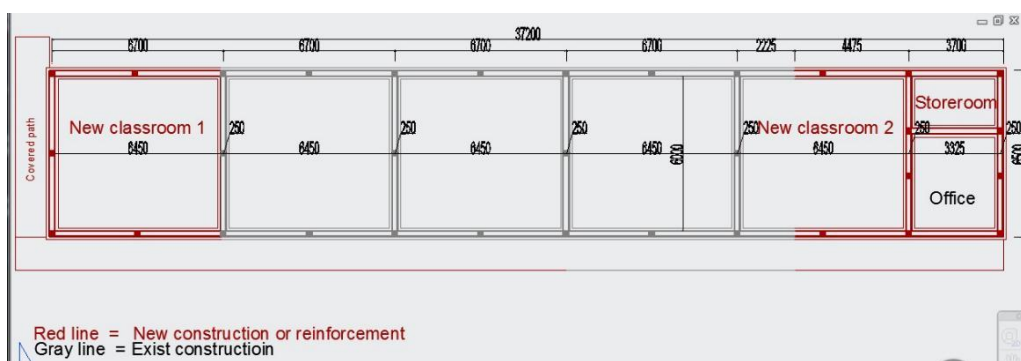

Plan drawing of the 2 new classrooms and store room and principals Office



**Original estimate.****Overall Totals for Nohona School.****Ariary****Euro**

Take 3850 Ar = 1 €

School Renovation

16,879,574

2 new classrooms

73,303,859

Latrines. 3 No Housing

6,265,126

Latrine Pit

6,305,453

Water Tank

7,558,529

**SUBTOTAL****110,312,541****28,652**

Playground, Gazebo, Seating etc

9,000,000

Desks and Furniture for 350 kids

12,000,000

**SUBTOTAL****21,000,000****5,454.**

Engineering costs for 12 months

**14,400,000****3,740****Total****145,708,541****37,846**

Contingency and Transport 10%

14,570,810

**3,784**